

POSITIVELY  
INTEGRATED  
BODES  
COMMUNITY  
HEALTH  
CENTER

101-141 BEARD STREET  
BROOKLYN, NEW YORK, NY, 11231

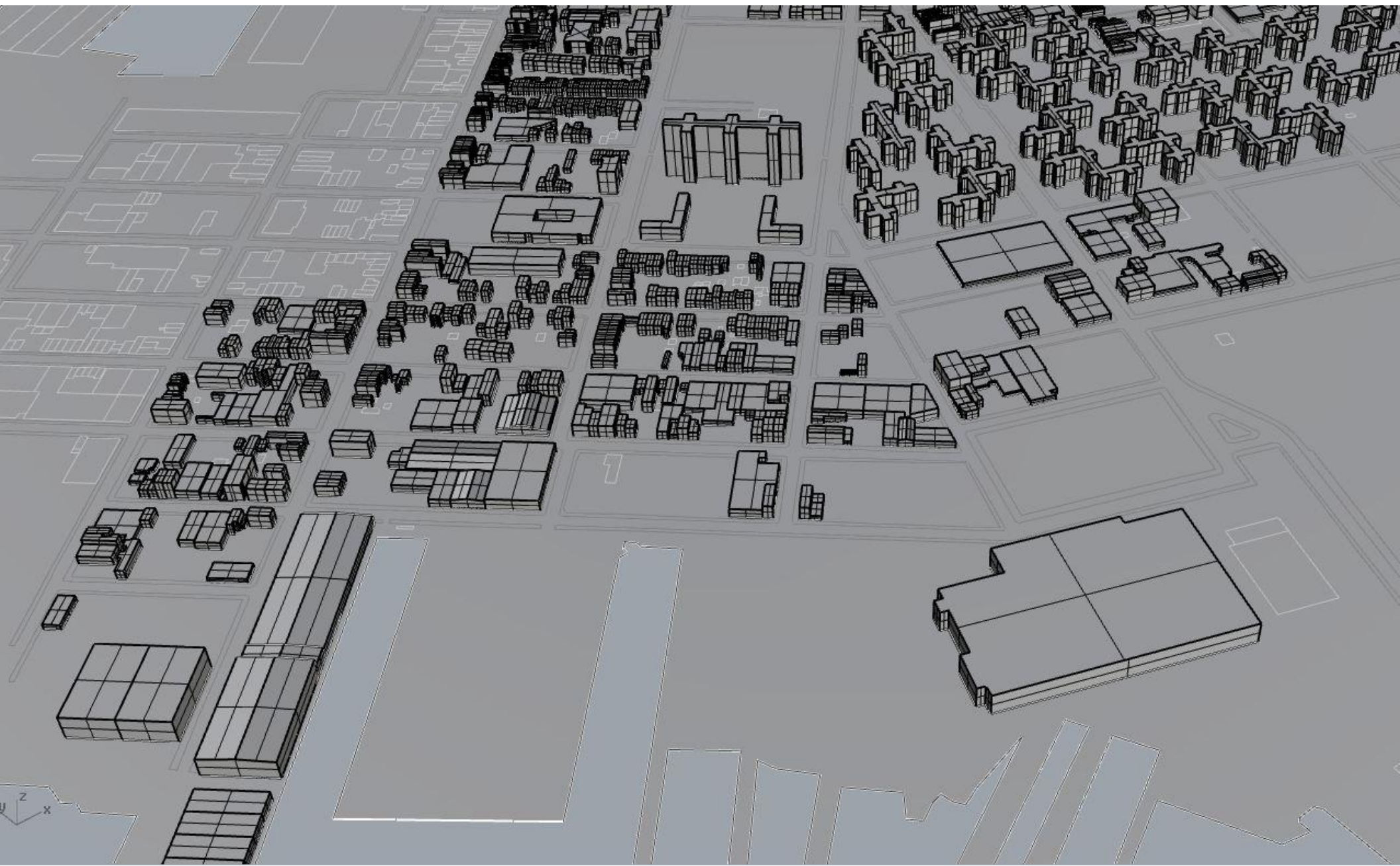

# THE SITE



# Roof Detail Green Roof

PAVED  
WALKWAY

LAWN

Perennial  
herbaceous  
Geranium Sue-  
Crug

Perennial  
Purple Bowl  
(*vernonia crinita*)

Perennial  
Golden  
Alexanders  
(*zizia aurea*)

Green Roof  
above treatment  
areas

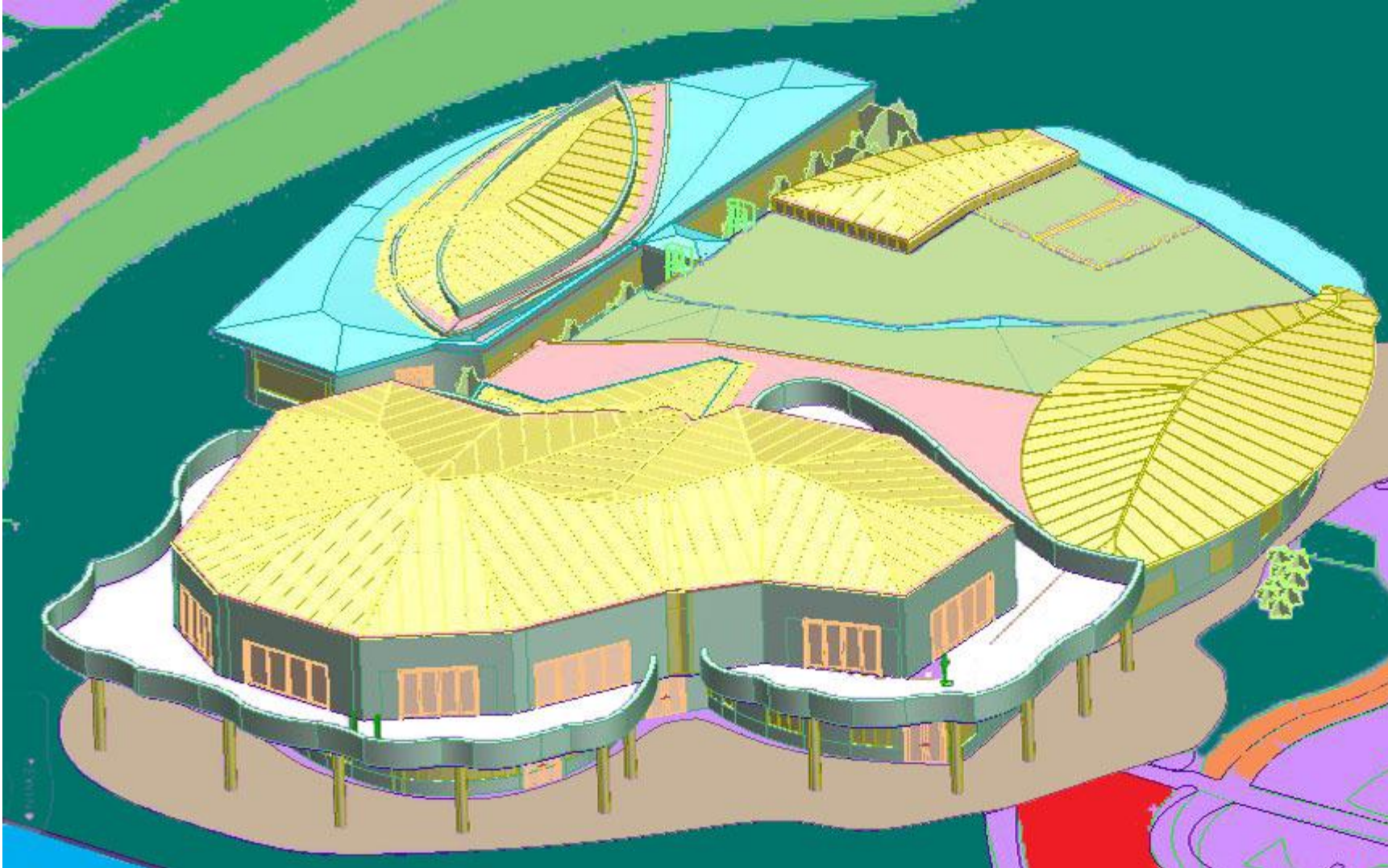



# Influences

## Pollution Remediation Wellesley College

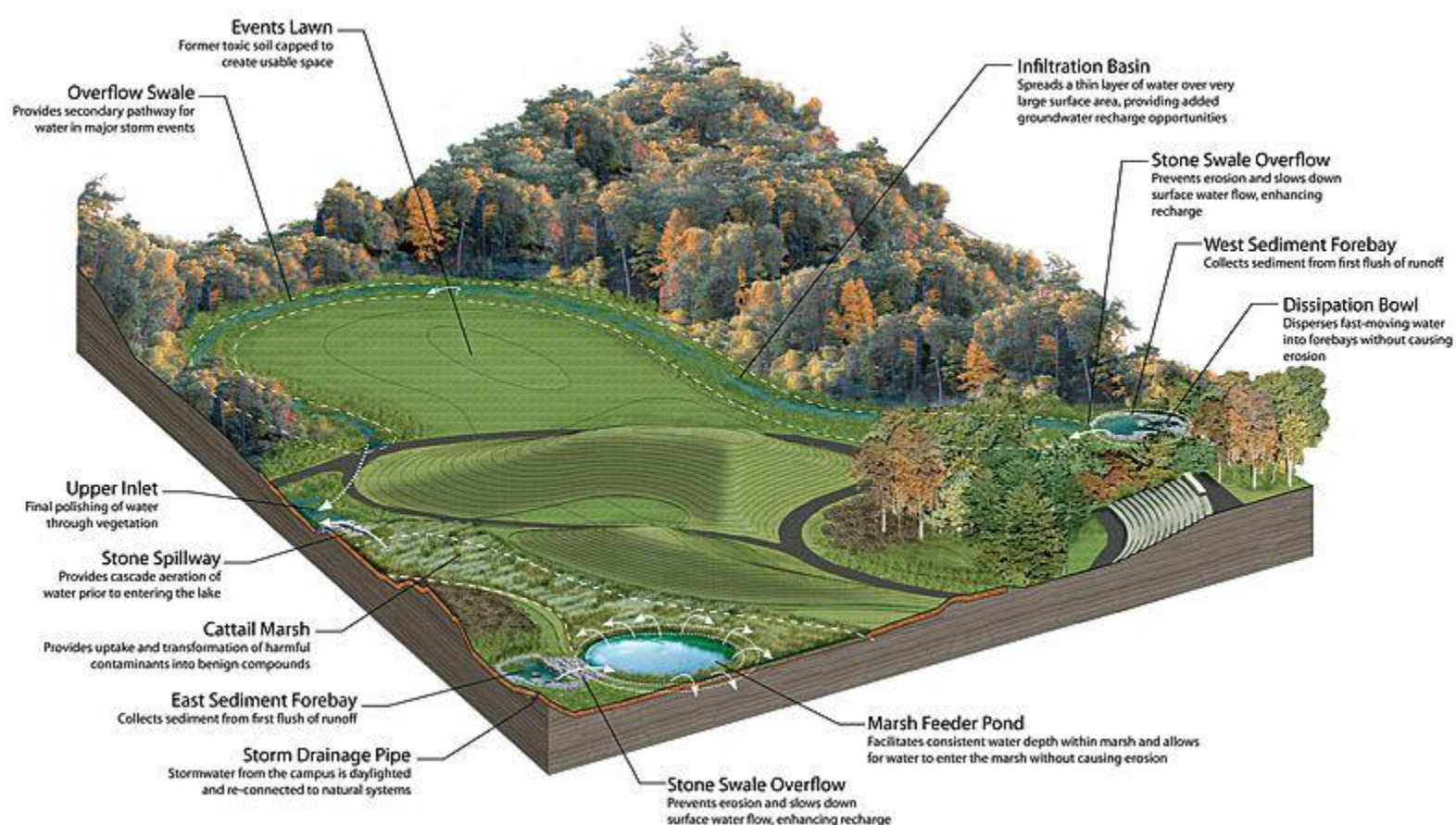



# Influences

Flood Resilience  
Brooklyn  
DUMBO area





# Influences

Habitat Recovery  
Bushwick Park



# Site Main Characteristics Abandonment Within Flood Zone

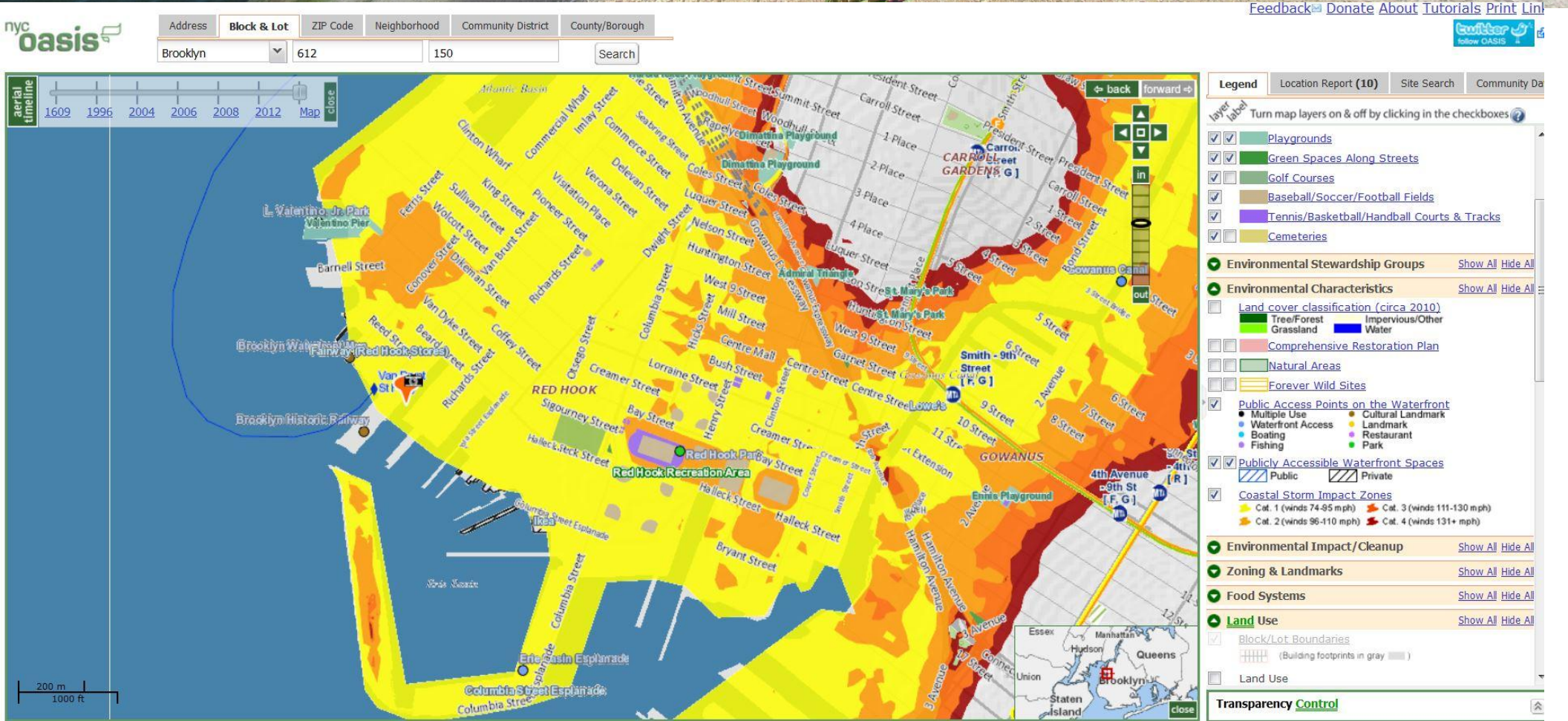

# Parti

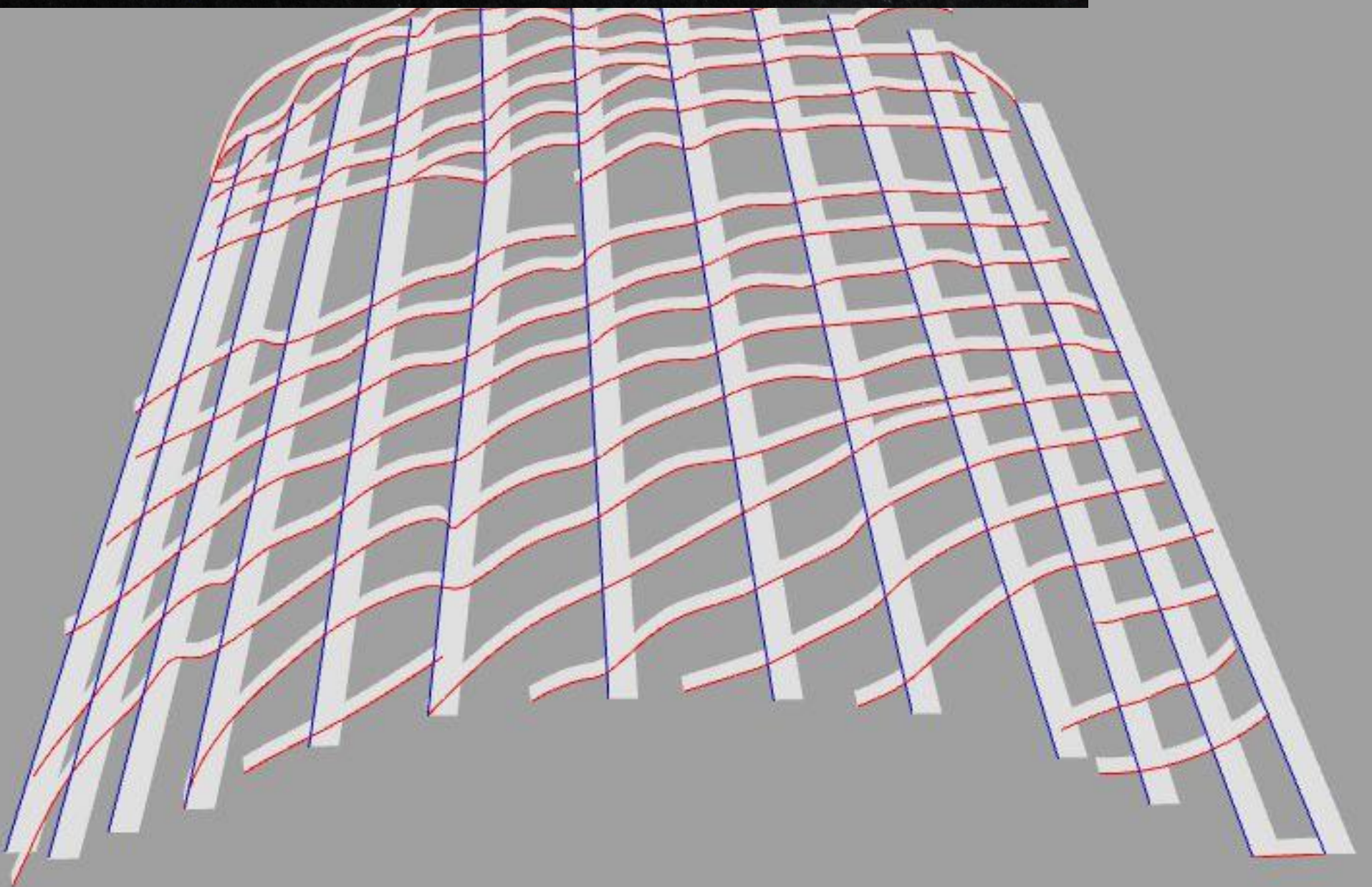



# Parti

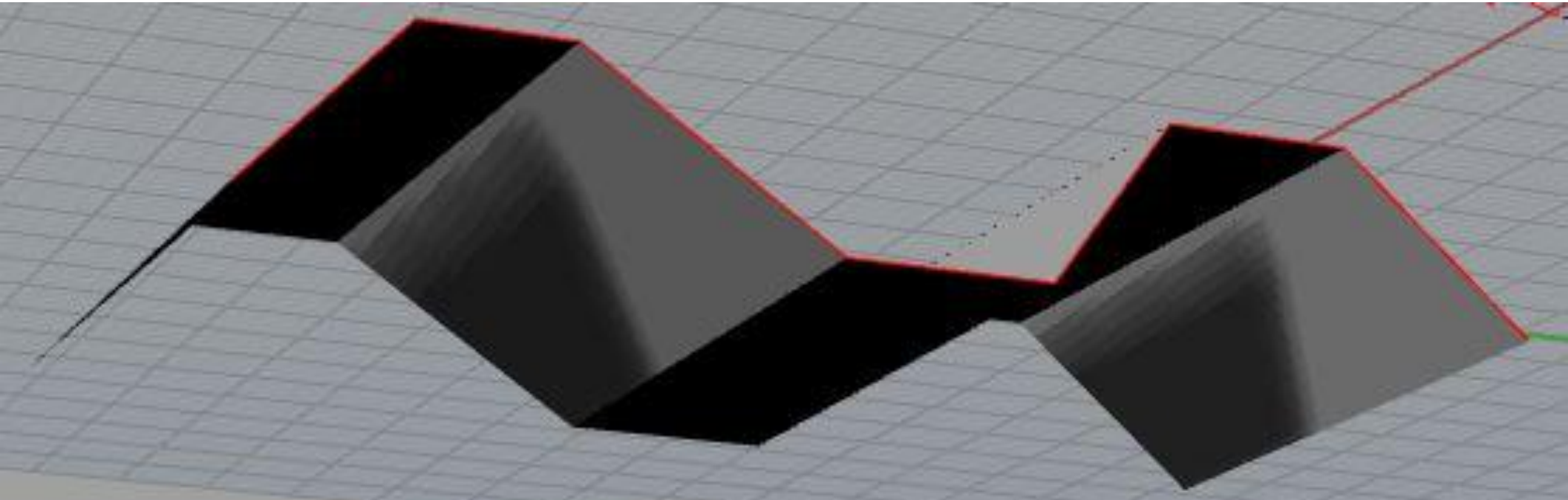

# Landscape Plants



BOXWOOD



BRUNETTE  
ACTAE  
GRASS

# INTERIOR PANELS

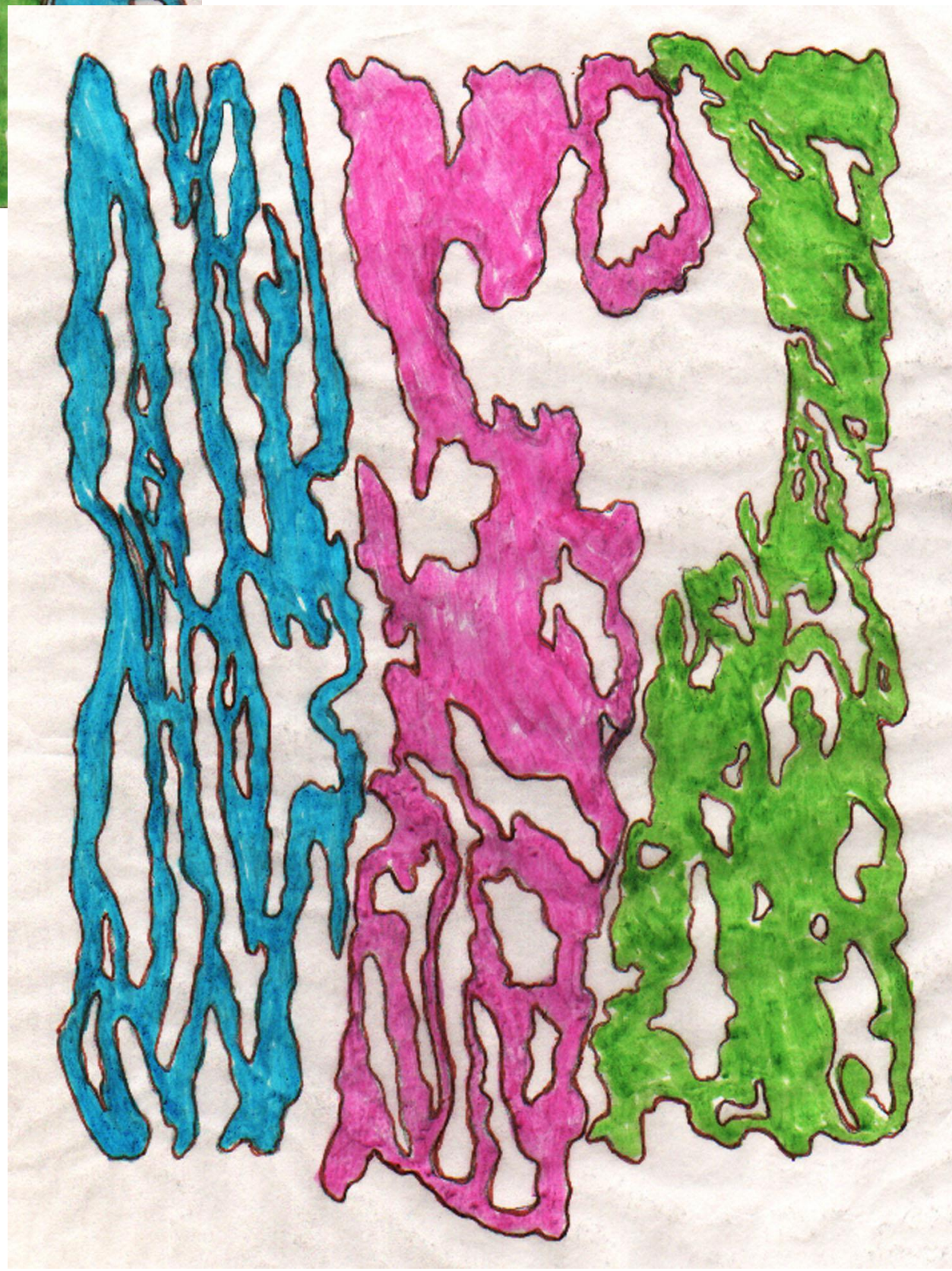

# PROPOSED LAYOUT

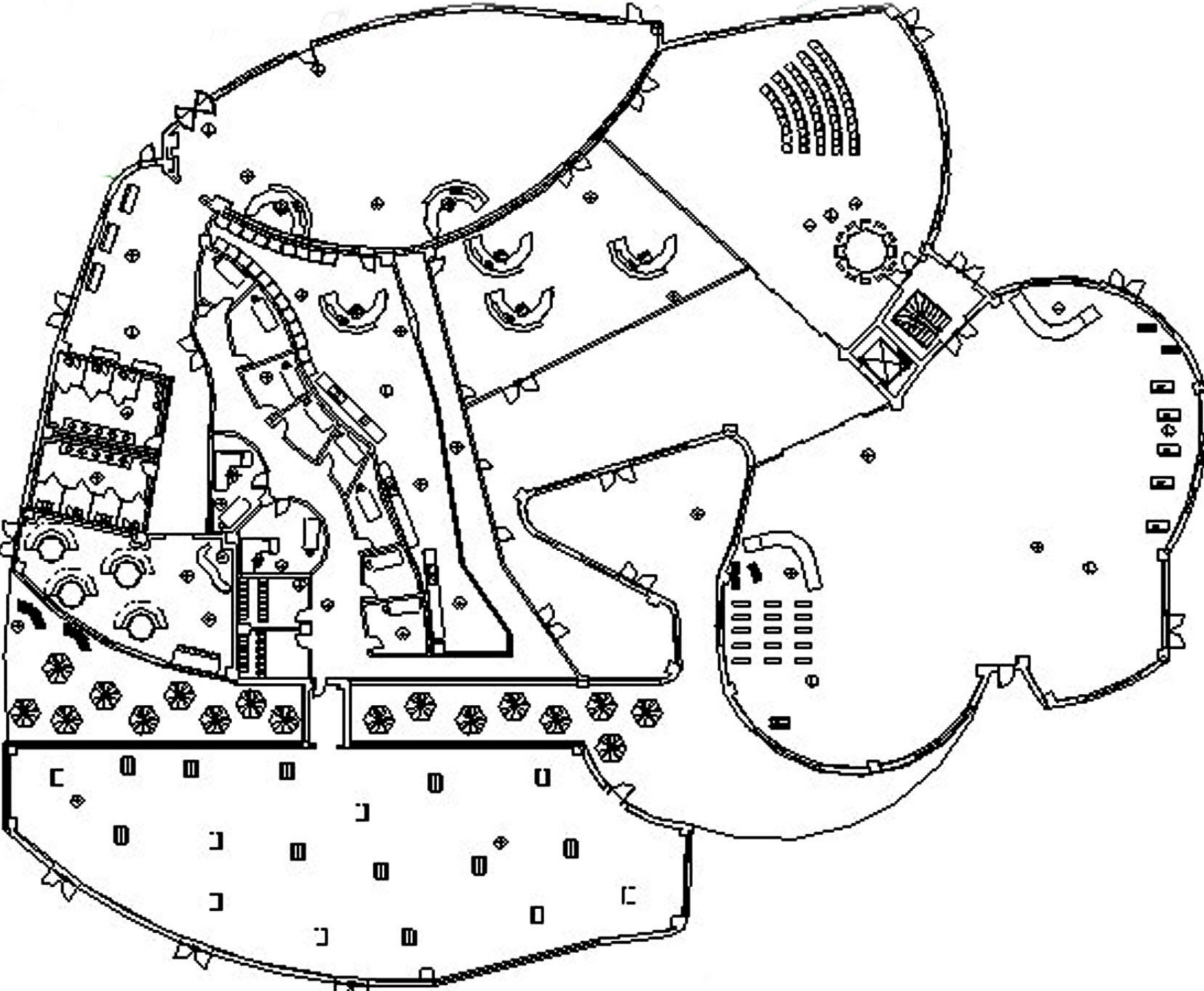
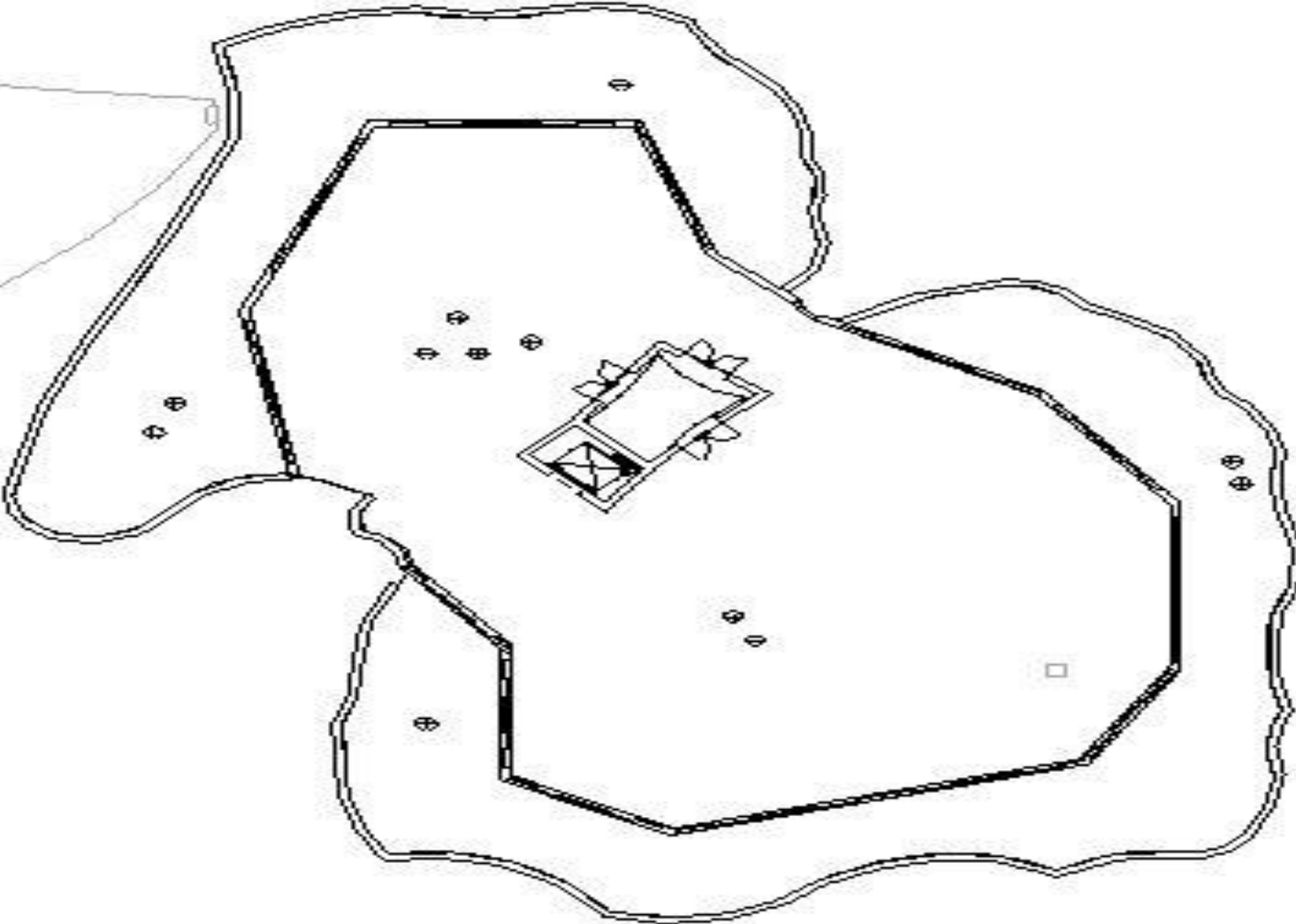



MAIN BUILDING

# SITE LAYOUT

